

Submittal: SDWSWH1012Z

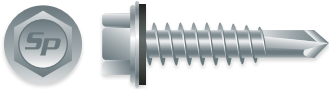

STRONG-POINT[®] UNSLOTTED INDENTED HEX WASHER HEAD, ZINC PLATED W/BONDED NEO-EPDM WASHER

Size	Part#	Pt.	Case Qty.	Description
10-16 x 3/4	HA1012	3	4M	Unslotted Indented Hex Washer Head, Zinc Plated w/Bonded NEO-EPDM Washer
10-16 x 1	HA1016	3	3M	Unslotted Indented Hex Washer Head, Zinc Plated w/Bonded NEO-EPDM Washer

Application: Attaches metal to metal.
Drill Capacity (in.): .035 - .176

- Specifications:
- Meets ASTM¹ C 1513 for cold-formed steel framing connections
 - Meets ASTM A 510 for carbon steel manufacturing
 - Manufactured to SAE² J78 for dimensional specifications
 - Meets F.I.P.³-1000.7 for torsional strength and drill speed
 - Meets ASTM F1941 for corrosion resistance
 - ICC-ES Evaluation Report: ESR-3528



Installation: A 5/16" hex nut setter or 5/16" drive socket with torque limiting nose piece set at a maximum of 2500 RPM drive speed recommended. Do not over torque as it can cause the head to snap or stripping of the threads. Installed fasteners must penetrate a minimum of three full threads beyond the metal structure.

Pullout Values (Avg. Lbs.)									
Fastener		Steel Gauge							
Size	Pt.	22	20	18	16	14	12	1/8	3/16
10-16	3	261	293	487	690	941	1432	2017	

Shear Values (Avg. Lbs.)									
Fastener		Steel Gauge (Lapped)							
Size	Pt.	22	20	18	16	14	12	1/8	3/16
10-16	3		709	1231	1497	1508			

The values listed are averages achieved under laboratory conditions and imply no warranty. Appropriate safety factors should be applied to these values for design purposes.

¹(American Society of Testing Materials)

²(Society of Automotive Engineers)

³(Fastener Inspection Products)