

**Submittal:** SDWSWH1020Z

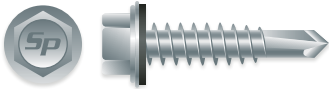

**STRONG-POINT<sup>®</sup> UNSLOTTED INDENTED HEX WASHER HEAD, ZINC PLATED W/BONDED NEO-EPDM WASHER**

Size	Part#	Pt.	Case Qty.	Description
10-16 x 1-1/4	HA1020	3	2.5M	Unslotted Indented Hex Washer Head, Zinc Plated w/Bonded NEO-EPDM Washer
10-16 x 1-1/2	HA1024	3	2M	Unslotted Indented Hex Washer Head, Zinc Plated w/Bonded NEO-EPDM Washer
10-16 x 2	HA1032	3	1.5M	Unslotted Indented Hex Washer Head, Zinc Plated w/Bonded NEO-EPDM Washer
10-16 x 2-1/2	HA1040	3	1M	Unslotted Indented Hex Washer Head, Zinc Plated w/Bonded NEO-EPDM Washer
10-16 x 3	HA1048	3	1M	Unslotted Indented Hex Washer Head, Zinc Plated w/Bonded NEO-EPDM Washer

Application: Attaches metal to metal.  
Drill Capacity (in.): .035 - .176

- Specifications:
- Meets ASTM<sup>1</sup> C 1513 for cold-formed steel framing connections
  - Meets ASTM A 510 for carbon steel manufacturing
  - Manufactured to SAE<sup>2</sup> J78 for dimensional specifications
  - Meets F.I.P.<sup>3</sup>-1000.7 for torsional strength and drill speed
  - Meets ASTM F1941 for corrosion resistance
  - ICC-ES Evaluation Report: ESR-3528



Installation: A 5/16" hex nut setter or 5/16" drive socket with torque limiting nose piece set at a maximum of 2500 RPM drive speed recommended. Do not over torque as it can cause the head to snap or stripping of the threads. Installed fasteners must penetrate a minimum of three full threads beyond the metal structure.

Pullout Values (Avg. Lbs.)									
Fastener		Steel Gauge							
Size	Pt.	22	20	18	16	14	12	1/8	3/16
10-16	3	261	293	487	690	941	1432	2017	

Shear Values (Avg. Lbs.)									
Fastener		Steel Gauge (Lapped)							
Size	Pt.	22	20	18	16	14	12	1/8	3/16
10-16	3		709	1231	1497	1508			

The values listed are averages achieved under laboratory conditions and imply no warranty. Appropriate safety factors should be applied to these values for design purposes.

<sup>1</sup>(American Society of Testing Materials)

<sup>2</sup>(Society of Automotive Engineers)

<sup>3</sup>(Fastener Inspection Products)

HA1020\_HA1048\_Rev. A (5/27/15)