

Submittal: SD4SWH0812BS

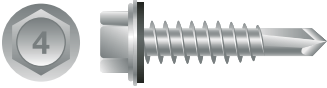

STRONG-POINT[®] 410 STAINLESS STEEL UNSLOTTED INDENTED HEX WASHER HEAD, PASSIVATED & WAXED W/BONDED NEO-EPDM WASHER

Size	Part#	Pt.	Case Qty.	Description
8-18 x 1/2	4HA808	2	5M	Unslotted Indented Hex Washer Head, Passivated & Waxed w/Bonded NEO-EPDM Washer
8-18 x 3/4	4HA812	2	5M	Unslotted Indented Hex Washer Head, Passivated & Waxed w/Bonded NEO-EPDM Washer
8-18 x 1	4HA816	2	4M	Unslotted Indented Hex Washer Head, Passivated & Waxed w/Bonded NEO-EPDM Washer

Application: Attaches metal to metal.
Drill Capacity (in.): .035 - .100

- Specifications:
- Manufactured to SAE¹ J78 for dimensional specifications
 - Meets F.I.P.²-1000.7 for torsional strength and drill speed
 - Medium degree of corrosion resistance

Installation: A 1/4" hex nut setter or 1/4" drive socket with torque limiting nose piece set at a maximum of 2500 RPM drive speed recommended. Do not over torque as it can cause the head to snap or stripping of the threads. Installed fasteners must penetrate a minimum of three full threads beyond the metal structure.

Pullout Values (Avg. Lbs.)									
Fastener		Steel Gauge							
Size	Pt.	22	20	18	16	14	12	1/8	3/16
8-18	2	260	292	479	685	933	1533		

Shear Values (Avg. Lbs.)									
Fastener		Steel Gauge (Lapped)							
Size	Pt.	22	20	18	16	14	12	1/8	3/16
8-18	2	546	721	1031	1049				

The values listed are averages achieved under laboratory conditions and imply no warranty. Appropriate safety factors should be applied to these values for design purposes.

¹(Society of Automotive Engineers)

²(Fastener Inspection Products)

4HA808_4HA816_Rev. A (7/7/15)